

Plot Date: 07 December 2023 11:14  
File Name: C:\Users\Jake\Arden\Management\Projects - Accom - H2 Teesside\IP16 - GIS & CAD Files\073\_ARDG - H2 Teesside\Arden\Projects\Re-Consultation Plans\073\_ARDG\_H2 Teesside\_LIC\_Batch\_1\_Church Commissioners England.aprx

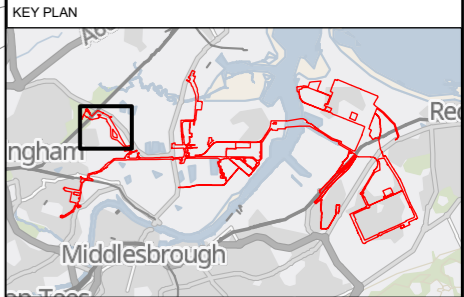
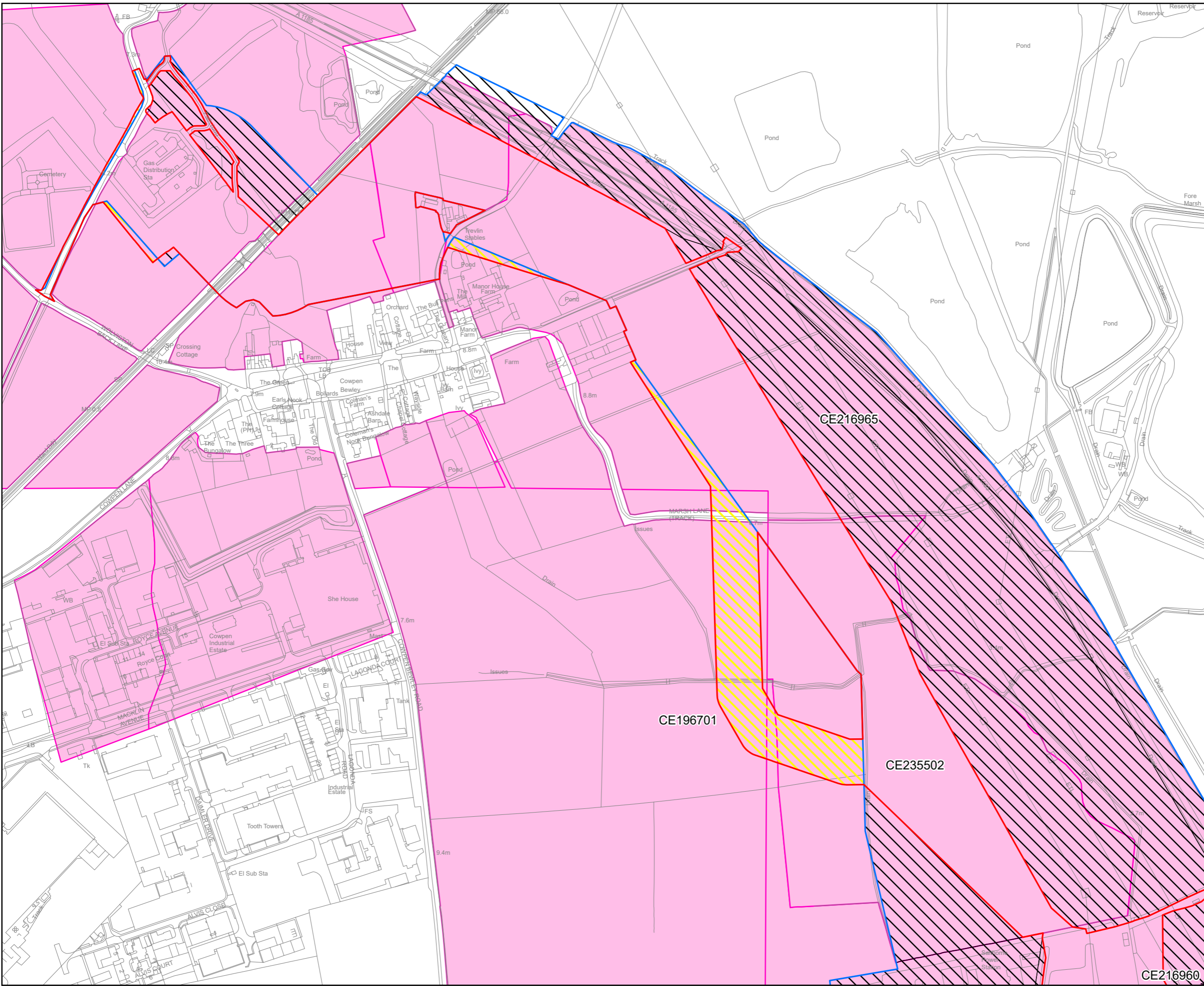

- Key
- Revised Draft Order Limits
  - Order Limits shown at Previous Statutory Consultation
  - Land Interest Boundary
  - Additional Land Area Required
  - Land Area Reduced

© Crown copyright and database rights 2023 Ordnance Survey 0100031673. You are permitted to use this data solely to enable you to respond to, or interact with, the organisation that provided you with the data. You are not permitted to copy, sub-licence, distribute or sell any of this data to third parties in any form.

© Crown copyright material is reproduced with the permission of Land Registry under delegated authority from the Controller of HMSO.

This material was last updated in September 2023 and may not be copied, distributed, sold or published without the formal permission of Land Registry. Only an official copy of a title plan or register obtained from the Land Registry may be used for legal or other official purposes.

May contain public sector information licensed under the Open Government Licence v3.0.



Project: H2 TEESSIDE

Drawing Title: STAGE 2 CONSULTATION LAND INTEREST PLAN CHURCH COMMISSIONERS FOR ENGLAND SHEET 1 OF 5

Status: FINAL	Revision: 000
Scale: 1:5,000 @ A3	Date: 07/12/2023

Spatial Reference System: British National Grid

Drawn By: J.NEYE-SWIFT	Checked By: N/A	Approved By: J.WITHINGTON
------------------------	-----------------	---------------------------

Drawing reference: 073\_ARDG\_H2Teesside\_LIC

This document is not to be used in whole or in part other than for the intended purpose and project for which it was prepared and provided.

Plot Date: 07 December 2023 11:14  
 File Name: C:\Users\JW\OneDrive\Management\Projects\Re-Consultation Plans\073\_ARDG\_H2Teesside\IP16 - GIS & CAD Files\073\_ARDG\_Teeside\ArCPro Projects\Re-Consultation Plans\073\_ARDG\_H2Teesside\_LIC\_Batch\_1\_Church Commissioners England.aprx

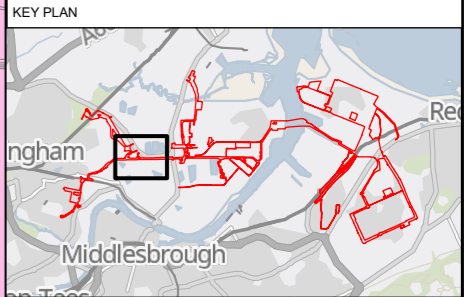
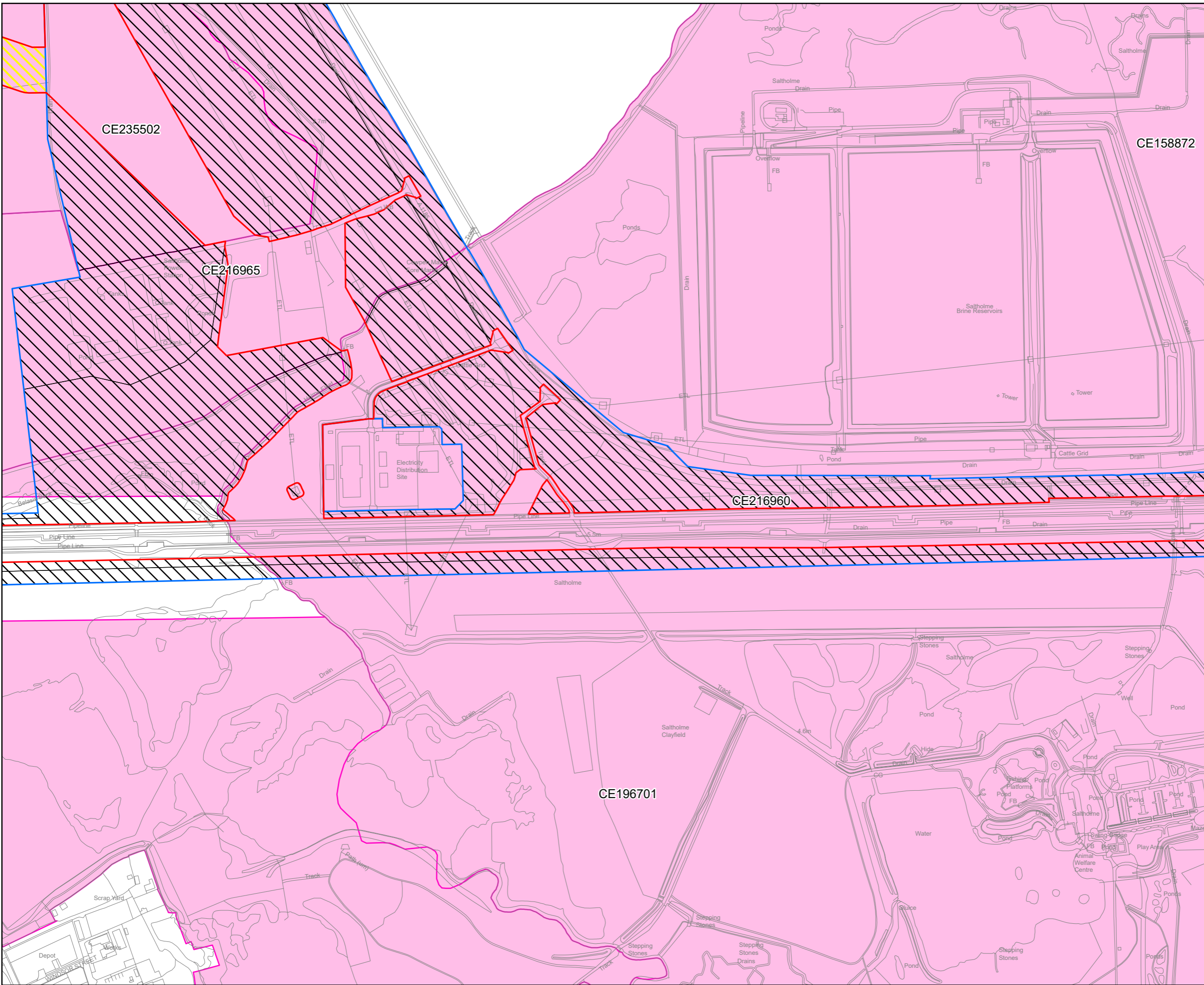

- Key**
- Revised Draft Order Limits
  - Order Limits shown at Previous Statutory Consultation
  - Land Interest Boundary
  - Additional Land Area Required
  - Land Area Reduced

© Crown copyright and database rights 2023 Ordnance Survey 0100031673. You are permitted to use this data solely to enable you to respond to, or interact with, the organisation that provided you with the data. You are not permitted to copy, sub-licence, distribute or sell any of this data to third parties in any form.

© Crown copyright material is reproduced with the permission of Land Registry under delegated authority from the Controller of HMSO.

This material was last updated in September 2023 and may not be copied, distributed, sold or published without the formal permission of Land Registry. Only an official copy of a title plan or register obtained from the Land Registry may be used for legal or other official purposes.

May contain public sector information licensed under the Open Government Licence v3.0.



Project **H2 TEESSIDE**

Drawing Title  
**STAGE 2 CONSULTATION  
 LAND INTEREST PLAN  
 CHURCH COMMISSIONERS FOR ENGLAND  
 SHEET 2 OF 5**

Status	<b>FINAL</b>	Revision	000
Date		Date	07/12/2023

Scale	1:5,000 @ A3	Spatial Reference System	British National Grid
Drawn By	J.NEYE-SWIFT	Checked By	N/A
Approved By	J.WITHINGTON		

Drawing reference **073\_ARDG\_H2Teesside\_LIC**

This document is not to be used in whole or in part other than for the intended purpose and project for which it was prepared and provided.

Plot Date: 07 December 2023 11:14  
 File Name: C:\Users\Jake\Arden Management Ltd\Projects - Aecom - H2 Teesside\Arden Management Ltd\Projects - Aecom - H2 Teesside\IP16 - GIS & CAD Files\073\_ARDG\_Teeside\Arden Management Ltd\Projects - Aecom - H2 Teesside\IP16 - GIS & CAD Files\073\_ARDG\_H2Teesside\_LIC\_Batch\_1\_Church Commissioners England.aprx

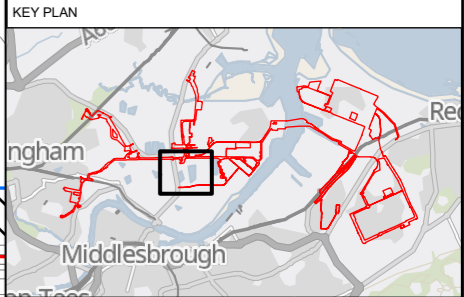
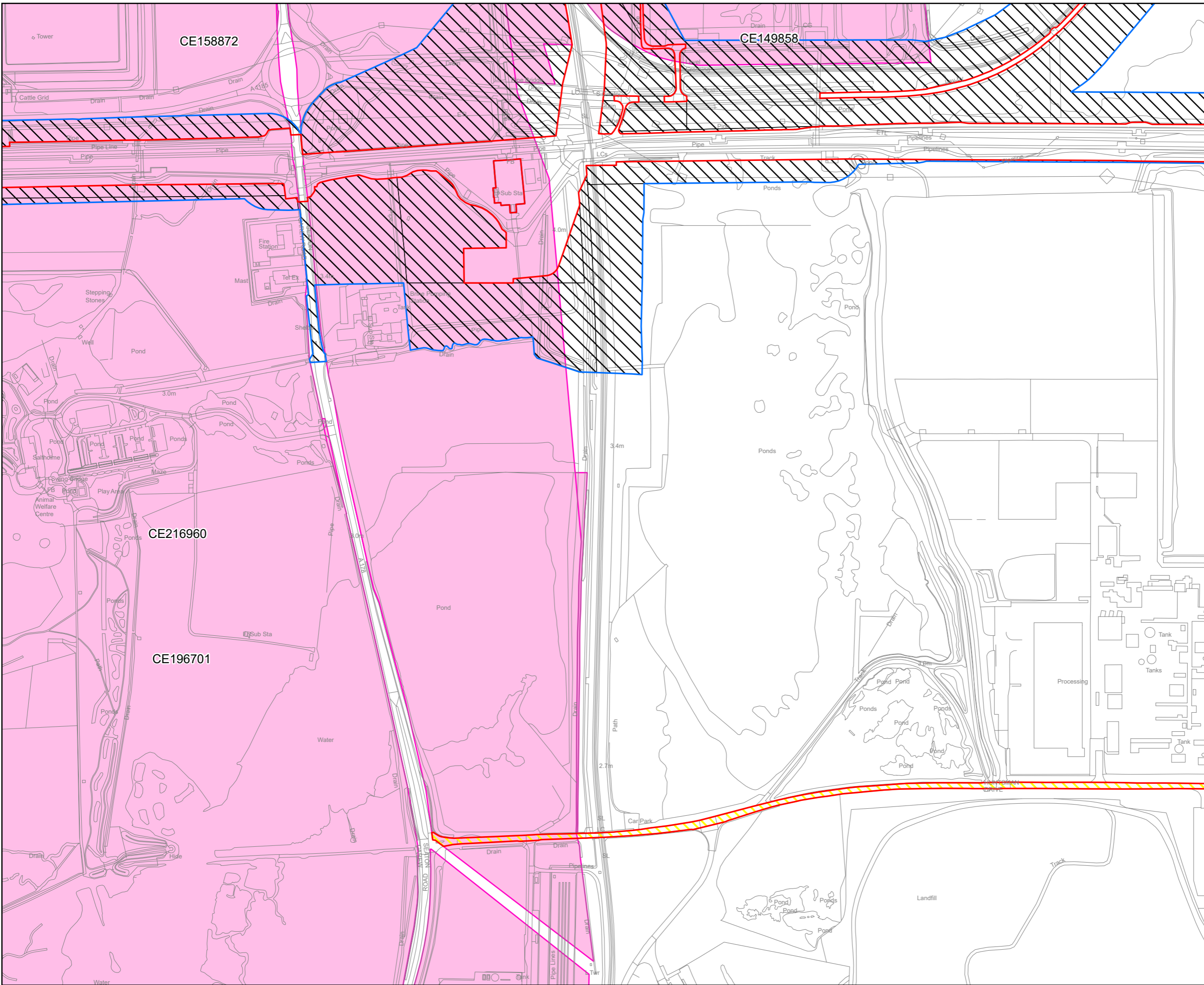

- Key**
- Revised Draft Order Limits
  - Order Limits shown at Previous Statutory Consultation
  - Land Interest Boundary
  - Additional Land Area Required
  - Land Area Reduced

© Crown copyright and database rights 2023 Ordnance Survey 0100031673. You are permitted to use this data solely to enable you to respond to, or interact with, the organisation that provided you with the data. You are not permitted to copy, sub-licence, distribute or sell any of this data to third parties in any form.

© Crown copyright material is reproduced with the permission of Land Registry under delegated authority from the Controller of HMSO.

This material was last updated in September 2023 and may not be copied, distributed, sold or published without the formal permission of Land Registry. Only an official copy of a title plan or register obtained from the Land Registry may be used for legal or other official purposes.

May contain public sector information licensed under the Open Government Licence v3.0.



Project: H2 TEESSIDE

Drawing Title: STAGE 2 CONSULTATION LAND INTEREST PLAN CHURCH COMMISSIONERS FOR ENGLAND SHEET 3 OF 5

Status	FINAL	Revision	000
Date	07/12/2023	Checked By	N/A
Scale	1:5,000 @ A3	Approved By	J.WITHINGTON
Spatial Reference System	British National Grid	Drawn By	J.NEYE-SWIFT
Drawing reference	073_ARDG_H2Teesside_LIC		

This document is not to be used in whole or in part other than for the intended purpose and project for which it was prepared and provided.

Plot Date: 07 December 2023 11:14  
 File Name: C:\Users\JW\OneDrive\Arden Management Ltd\Projects - Aecom - H2 Teesside\Arden Management Ltd\Projects - Aecom - H2 Teesside\IP16 - GIS & CAD Files\073\_ARDG\_H2Teesside\_LIC\_Batch\_1\_Church Commissioners England.aprx

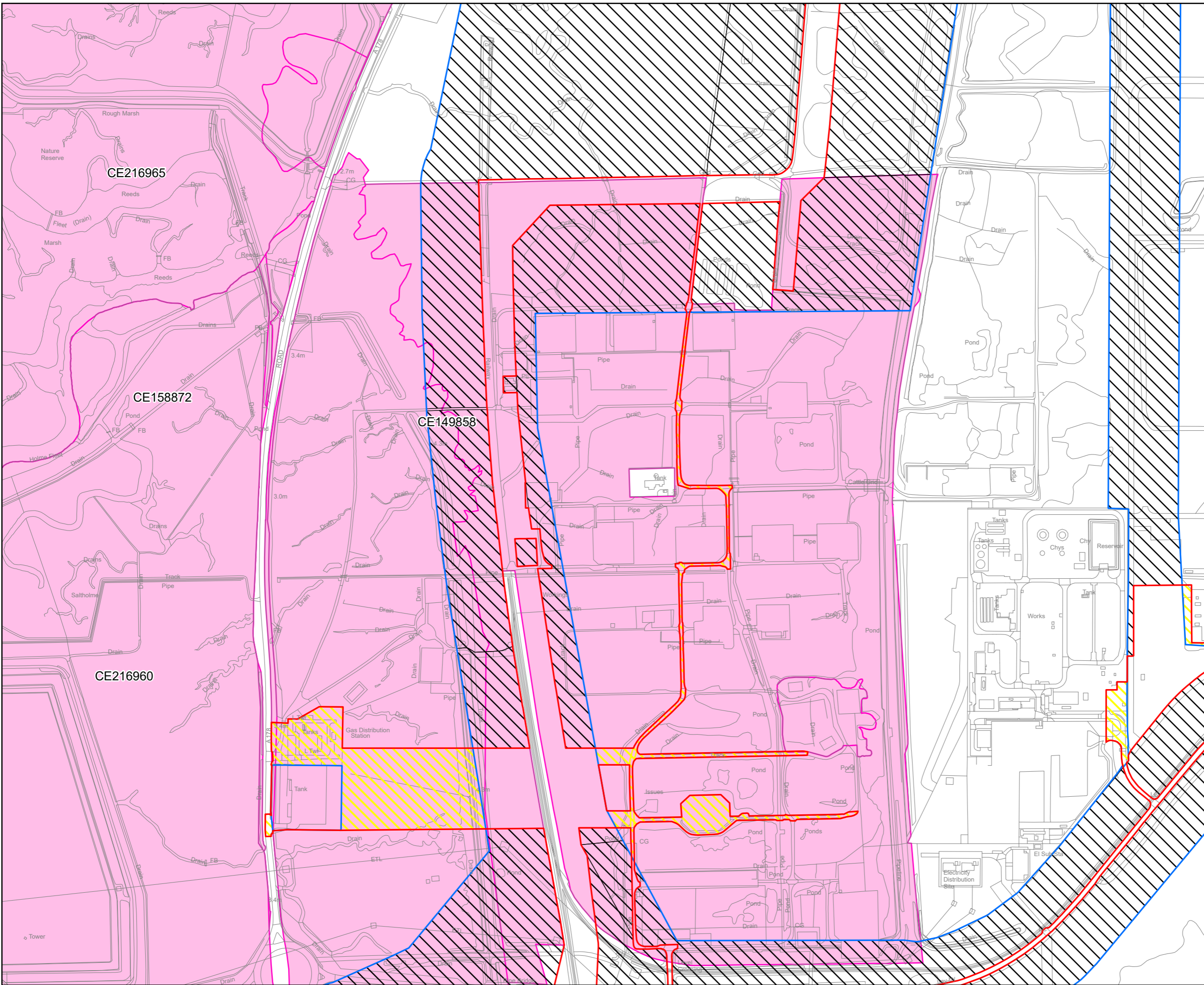

**KEY PLAN**

**Key**

- Revised Draft Order Limits
- Order Limits shown at Previous Statutory Consultation
- Land Interest Boundary
- Additional Land Area Required
- Land Area Reduced

© Crown copyright and database rights 2023 Ordnance Survey 0100031673. You are permitted to use this data solely to enable you to respond to, or interact with, the organisation that provided you with the data. You are not permitted to copy, sub-licence, distribute or sell any of this data to third parties in any form.

© Crown copyright material is reproduced with the permission of Land Registry under delegated authority from the Controller of HMSO.

This material was last updated in September 2023 and may not be copied, distributed, sold or published without the formal permission of Land Registry. Only an official copy of a title plan or register obtained from the Land Registry may be used for legal or other official purposes.

May contain public sector information licensed under the Open Government Licence v3.0.

Client

Designer

Project

H2 TEESSIDE

Drawing Title

STAGE 2 CONSULTATION  
 LAND INTEREST PLAN  
 CHURCH COMMISSIONERS FOR ENGLAND  
 SHEET 4 OF 5

Status	FINAL	Revision	000
Date	07/12/2023		
Scale	1:5,000 @ A3	Spatial Reference System	British National Grid
Drawn By	J.NEYE-SWIFT	Checked By	N/A
Approved By	J.WITHINGTON		
Drawing reference	073_ARDG_H2Teesside_LIC		

This document is not to be used in whole or in part other than for the intended purpose and project for which it was prepared and provided.

Plot Date: 07 December 2023 11:14  
File Name: C:\Users\Jaken\Arden\Management\Projects\Re-Consultation Plans\073\_ArdG\_H2Teesside\_LIC\_Batch\_1\_Church Commissioners England.aprx

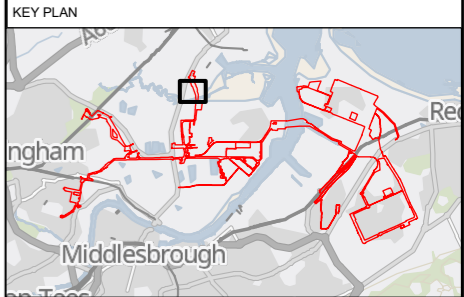
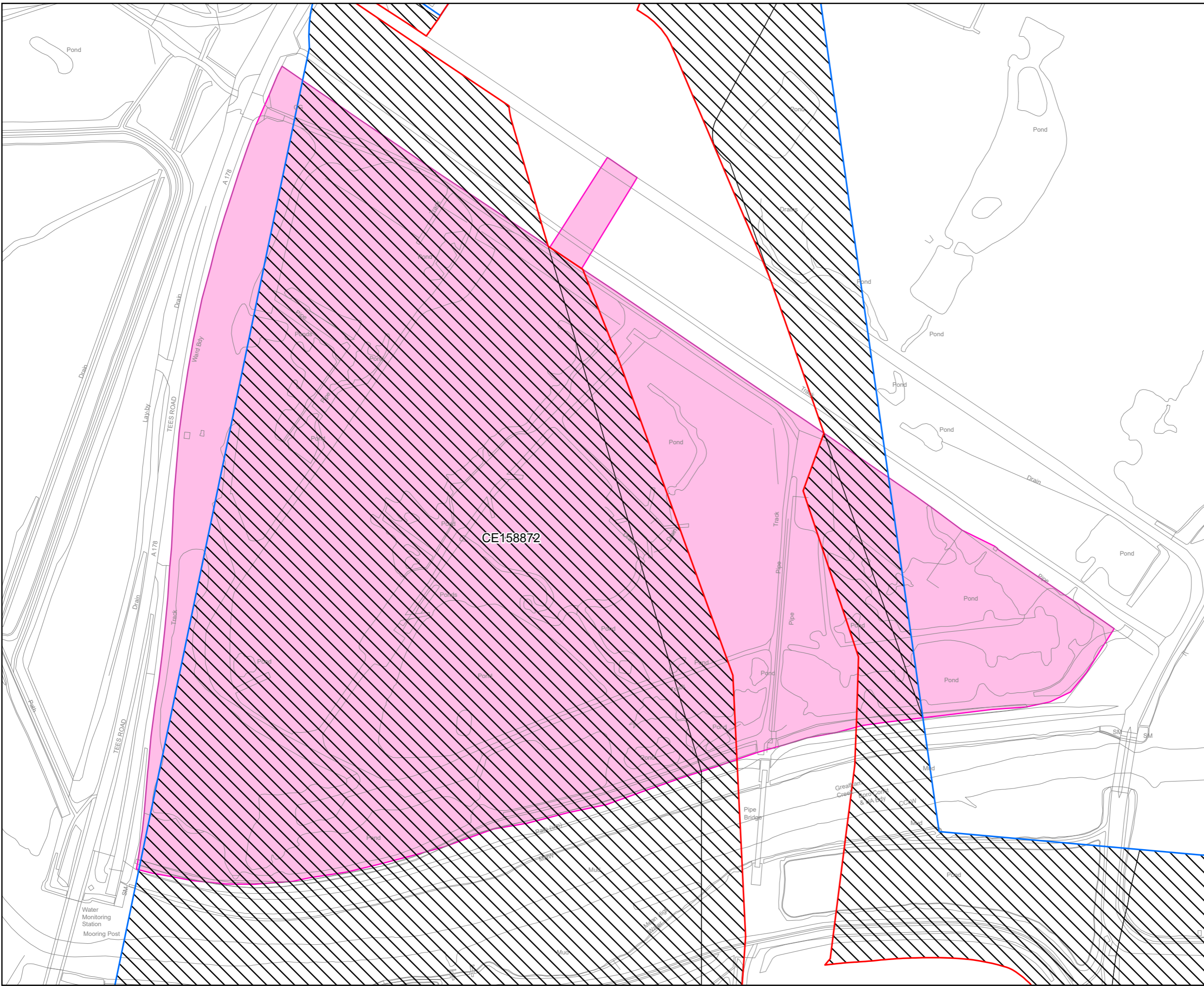

- Key
- Revised Draft Order Limits
  - Order Limits shown at Previous Statutory Consultation
  - Land Interest Boundary
  - Land Area Reduced

© Crown copyright and database rights 2023 Ordnance Survey 0100031673. You are permitted to use this data solely to enable you to respond to, or interact with, the organisation that provided you with the data. You are not permitted to copy, sub-licence, distribute or sell any of this data to third parties in any form.

© Crown copyright material is reproduced with the permission of Land Registry under delegated authority from the Controller of HMSO.

This material was last updated in September 2023 and may not be copied, distributed, sold or published without the formal permission of Land Registry. Only an official copy of a title plan or register obtained from the Land Registry may be used for legal or other official purposes.

May contain public sector information licensed under the Open Government Licence v3.0.



Project H2 TEESSIDE

Drawing Title  
**STAGE 2 CONSULTATION  
LAND INTEREST PLAN  
CHURCH COMMISSIONERS FOR ENGLAND  
SHEET 5 OF 5**

Status	FINAL	Revision	000
Scale	1:2,500 @ A3	Date	07/12/2023
Spatial Reference System	British National Grid		
Drawn By	J.NEYE-SWIFT	Checked By	N/A
Approved By	J.WITHINGTON		
Drawing reference	073_ArdG_H2Teesside_LIC		

This document is not to be used in whole or in part other than for the intended purpose and project for which it was prepared and provided.